



NS-2

Bedside cabinets



Part of the nursing beds

Bedside cabinet are an integral accessory of nursing beds. They increase the comfort and independence of client during hospitalisation and at the same time reduce the burden on the nursing staff.

NS-2

Double-sided table with wooden body suitable for nursing area.

Increases client comfort and the range of colours ensures a perfect match with the room interior.

Thanks to the double-sided design, the contents of the table are always easily accessible in any position.



Drawer

The drawer with a drop-out safety catch can be supplemented with a lock (independent or as a central key system), so that the patient's personal belongings are always safe.



Towel holder

The bedside table can also include a towel holder. The holder is located on the side of the table, this way the client will always have the towel at hand.

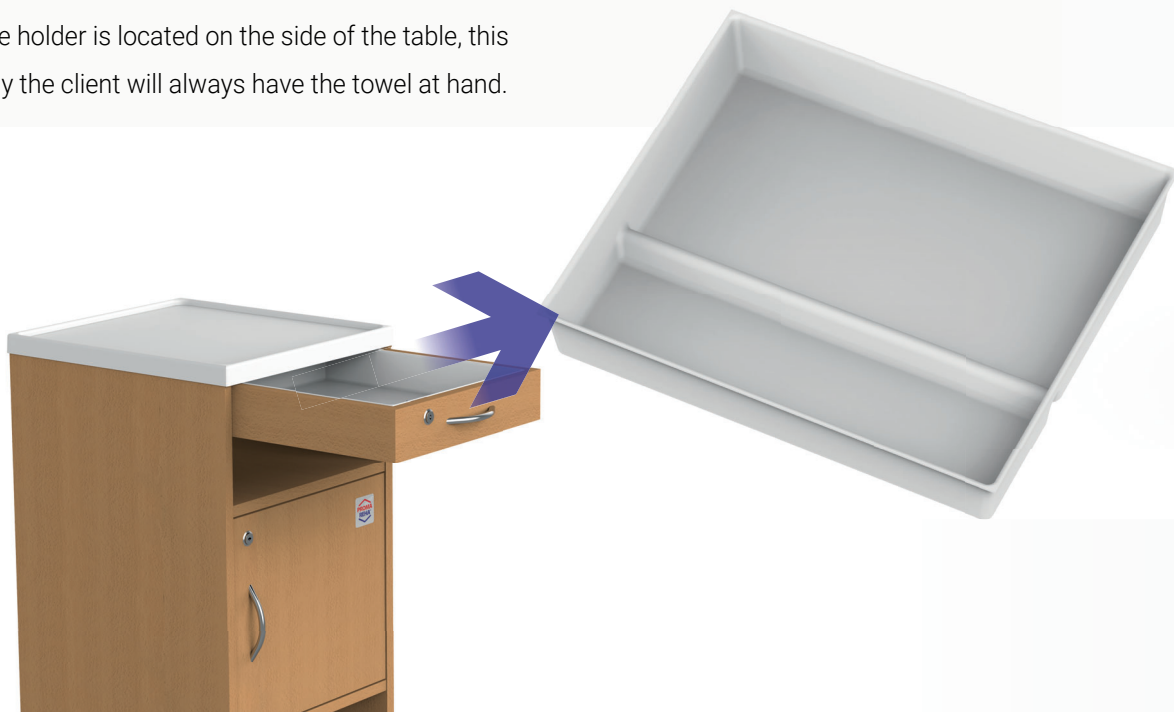

Plastic drawer insert

The plastic drawer insert is divided into two parts for easier organisation of personal belongings. It is also easily removable and cleanable.

Easily accessible shelf

The open storage shelf is particularly suitable for personal items of frequent daily use.



Container

Container with space for personal belongings and enough height for a PET bottle. The double sided design of the container is a versatile solution that allows the use of a bedside table on both sides of the bed.

Storage space for shoes

A practical shoe storage compartment is located at the bottom of the table.





TENTE brand castors

The braked plastic castors ensure easy handling of the bedside cabinet.

Lockable drawer and container

The drawer and container can be locked on request. The client does not have to worry about losing personal items.



Choice of design

The choice of colour design allows you to create an aesthetic and pleasant space for clients and staff that can help improve mood, comfort and reduce stress.

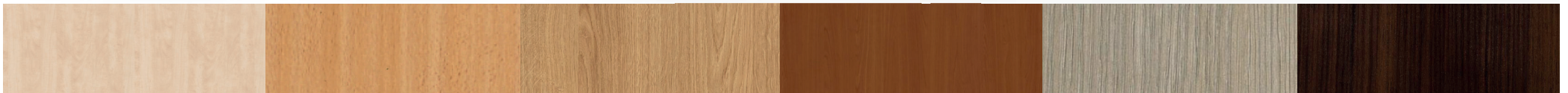

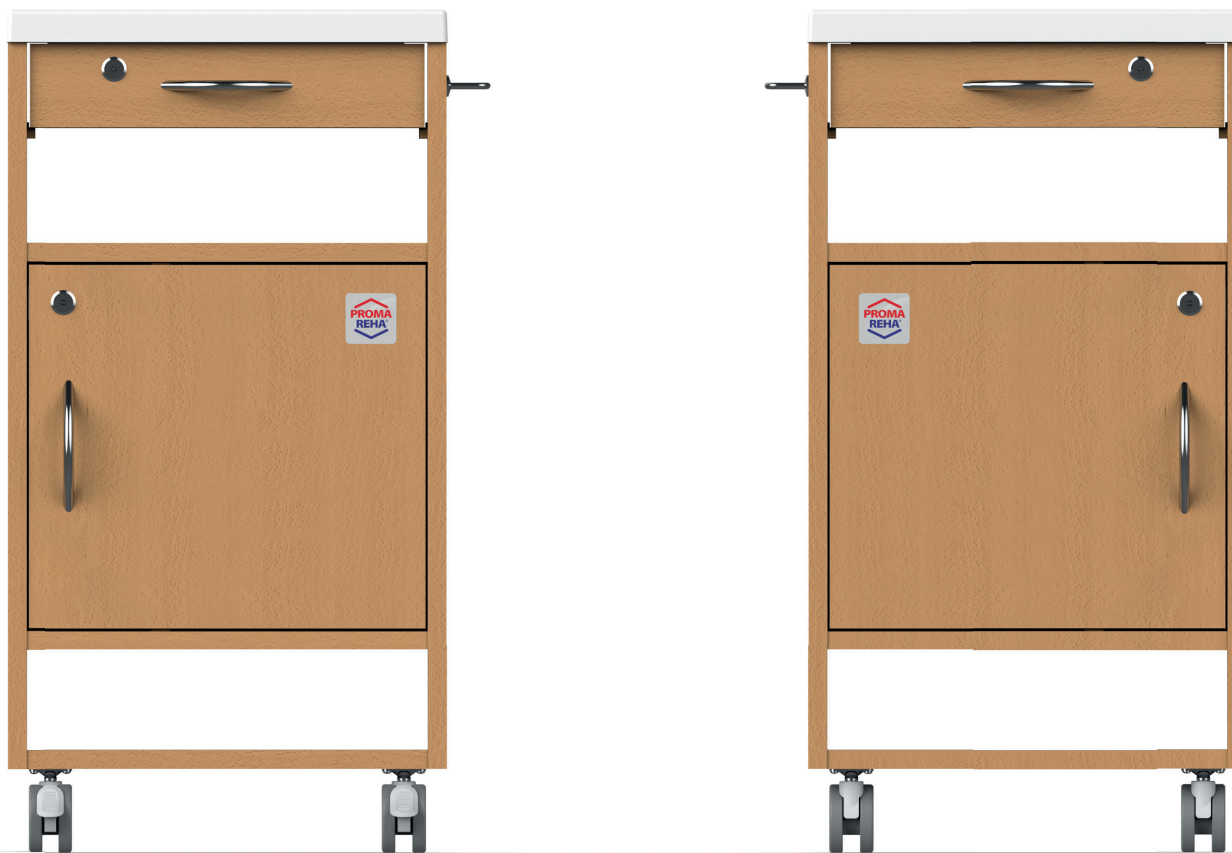

Technical parameters

Outer dimension (w x d x h)	42 x 49 x 81 cm
Door and drawer height.....	35/8 cm
Weight.....	26 kg
Design.....	Double -sided
Castors with brake	65 mm

